

MVK Series

● 105°C 1,000~ 2,000Hrs assured

- Vertical SMD type
- Wide Temperature range
- EMVK Series : Ecological capacitors with the same characteristics as MVK

Solvent-proof

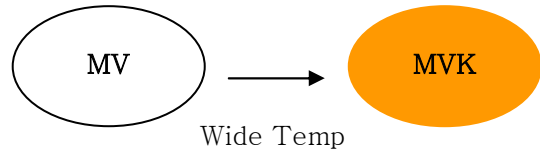

SPECIFICATIONS

Item	Characteristics						
Rated Voltage Range	6.3 ~ 50V _{DC}						
Operating Temperature Range	-40 ~ +105°C						
Capacitance Tolerance	±20% (M)						(at 20°C, 120Hz)
Leakage Current	I = 0.01CV or 3μA, whichever is greater Where, I : Leakage current(μA), C : Nominal capacitance(μF), V: Rated voltage(V _{DC}) (at 20°C, 2 minutes)						
Dissipation Factor (Tanδ)	Rated Voltage(V _{DC})	6.3	10	16	25	35	50
	∅ 4~ ∅ 6.3	0.30	0.24	0.20	0.16	0.14	0.12
	∅ 8~ ∅ 10	0.40	0.30	0.26	0.16	0.14	0.12
(at 20°C, 120Hz)							
Temperature Characteristics (Max. Impedance ratio)	Rated Voltage(V _{DC})	6.3	10	16	25	35 ~ 50	
	Z(-25°C)/Z(20°C)	4	3	2	2	2	
	Z(-40°C)/Z(20°C)	10	8	6	4	3	
(at 120Hz)							
Load Life	The following specifications shall be satisfied when the capacitors are restored to 20°C after the rated voltage applied with the following conditions. ∅ 4~ ∅ 6.3 : 105°C, 1,000hours. ∅ 8 & ∅ 10 : 105°C, 2,000hours Capacitance change ∅ 4~ ∅ 6.3 ≤ ± 30% of the initial value ∅ 8~ ∅ 10 ≤ ± 20% of the initial value Tanδ ∅ 4~ ∅ 6.3 ≤ 300% of the initial specified value ∅ 8~ ∅ 10 ≤ 200% of the initial specified value Leakage current ≤ The initial specified value						
Shelf Life	The following specifications shall be satisfied when the capacitors are restored to 20°C after exposing them for the specified time at 105°C without voltage applied.. ∅ 4~ ∅ 6.3 : 105°C 500 hours. ∅ 8 & ∅ 10 : 105°C, 1,000 hours Capacitance change ∅ 4~ ∅ 6.3 ≤ ± 25% of the initial value ∅ 8~ ∅ 10 ≤ ± 20% of the initial value Tanδ ≤ 200% of the initial specified value Leakage current ≤ The initial specified value						
Others	Satisfied characteristics W of KS C 6421						

PART NUMBERING SYSTEM

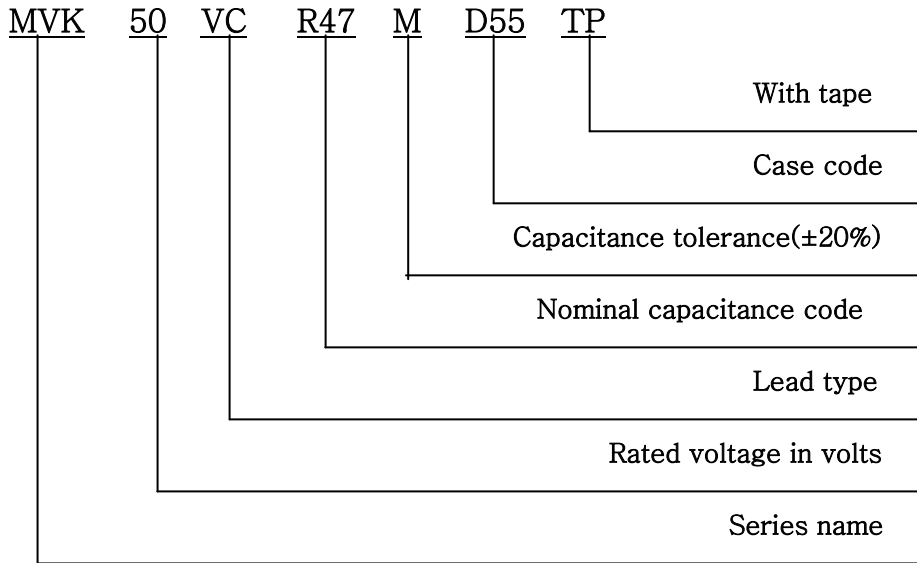

Capacitance	Code
0.1 μF	R1
0.47 μF	R47
1.0 μF	1
4.7 μF	4R7
10 μF	10
100 μF	100

DIMENSIONS OF MVK Series (Type :VC)

DIMENSIONS

Marking

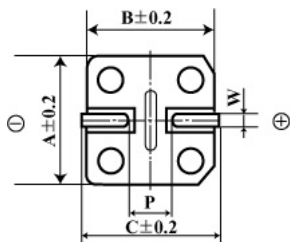
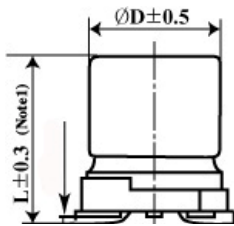
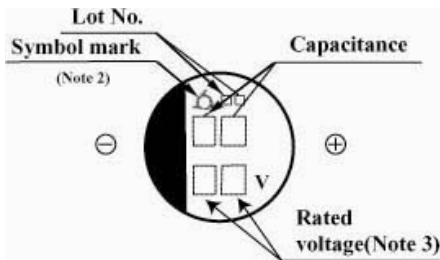

Recommended solder land on PC board

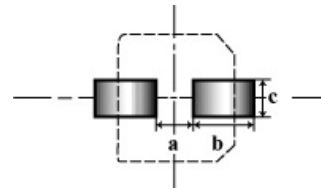

 **Sold land on PC board**

Note 1 : L + 0.5 for 8 x 6.3 (H63), 8 x 10 (H10), 10 x 10 (J10)

Note 2 : 4 x 5.2 (D55), 5 x 5.2 (E55) is excluded symbol mark

Note 3 : 6.3WV is marked by 6V.

Case code	∅ D	L	A	B	C	W	P	a	b	c
D55	4	5.2	4.3	4.3	5.1	0.5-0.8	1.0	1.0	2.6	1.6
E55	5	5.2	5.3	5.3	5.9	0.5-0.8	1.4	1.4	3.0	1.6
F55	6.3	5.2	6.6	6.6	7.2	0.5-0.8	1.9	1.9	3.5	1.6
F60	6.3	5.7	6.6	6.6	7.2	0.5-0.8	1.9	1.9	3.5	1.6
H63	8	6.3	8.3	8.3	9.0	0.5-0.8	2.3	2.3	4.5	1.6
H10	8	10.0	8.3	8.3	9.0	0.7-1.1	3.1	3.1	4.2	2.2
J10	10	10.0	10.3	10.3	11.0	0.7-1.1	4.5	4.5	4.4	2.2

